

# 805 VESUVIUS BAY ROAD

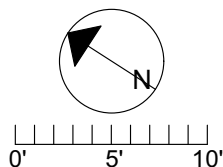

**MAIN FLOOR**  
 1978 SQ.FT

	FINISHED SQ. FT.	UNFINISHED SQ. FT.	TOTAL SQ. FT.
MAIN	1978	0	1978
LOWER	0	1921	1921
<b>TOTAL</b>	<b>1978</b>	<b>1921</b>	<b>3899</b>
PORCH	0	2109	2109
SHED	0	92	92



PREPARED FOR THE EXCLUSIVE USE OF  
 CHRIS & DARLENE HOBBS OF  
 SOTHEBY'S INTERNATIONAL REALTY CANADA

---

MEASURED ON: 08.25.20  
 DRAWING FILE: 0291

NOTE: This floor plan is provided by Chris & Darlene Hobbs of Sotheby's International Realty Canada as a convenient reference only, and is not to be relied upon as accurate. Prospective Buyers must satisfy themselves not only of the actual measurements, but also to the status of any finished space shown on this floor plan, specifically in relation to minimum ceiling height for habitable rooms required by the BC Building Code, allowable finished floor area in relation to current zoning, and determination if space was developed with necessary municipal permits.

# 805 VESUVIUS BAY ROAD

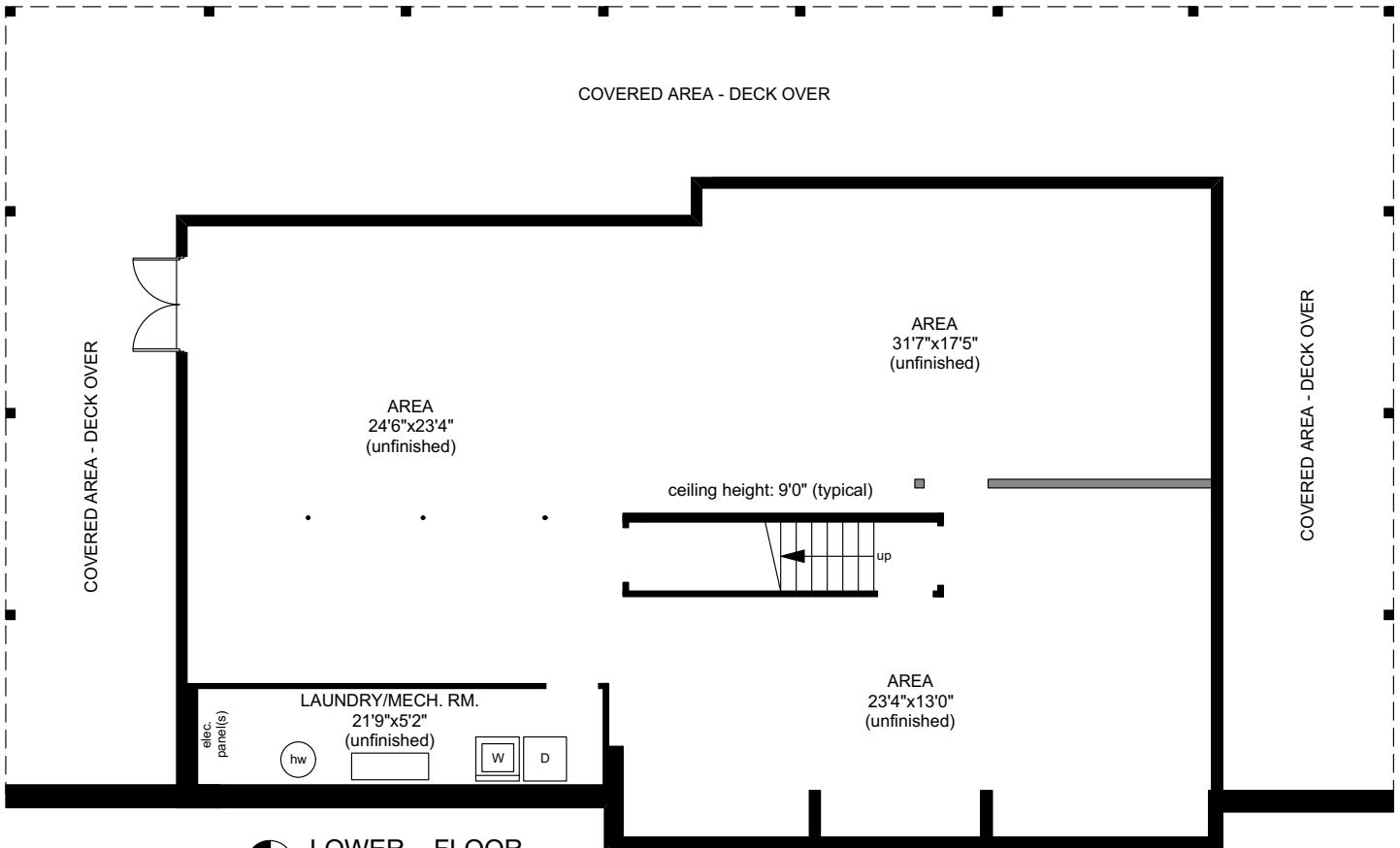

**LOWER FLOOR**  
 1921 SQ.FT

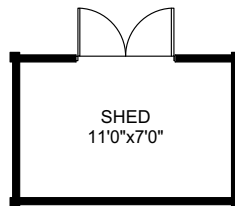

	FINISHED SQ. FT.	UNFINISHED SQ. FT.	TOTAL SQ. FT.
MAIN	1978	0	1978
LOWER	0	1921	1921
<b>TOTAL</b>	<b>1978</b>	<b>1921</b>	<b>3899</b>
PORCH	0	2109	2109
SHED	0	92	92

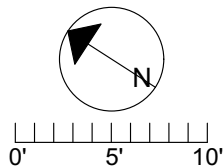

PREPARED FOR THE EXCLUSIVE USE OF  
 CHRIS & DARLENE HOBBS OF  
 SOTHEBY'S INTERNATIONAL REALTY CANADA

---

MEASURED ON: 08.25.20  
 DRAWING FILE: 0291

NOTE: This floor plan is provided by Chris & Darlene Hobbs of Sotheby's International Realty Canada as a convenient reference only, and is not to be relied upon as accurate. Prospective Buyers must satisfy themselves not only of the actual measurements, but also to the status of any finished space shown on this floor plan, specifically in relation to minimum ceiling height for habitable rooms required by the BC Building Code, allowable finished floor area in relation to current zoning, and determination if space was developed with necessary municipal permits.